



Dear Community Members:

One of the things the past weeks and months have taught us is that our schools play a critical role in our community. I am proud of how our students, staff, parents, and the greater community have come together to meet the various challenges. Together, we have successfully moved to distance learning, found creative ways for our students and staff to connect, and are providing breakfast and lunch for many of our students. Whatever the challenge, we remain committed to fulfilling our mission of “*Preparing Students for What Comes Next!*”

During challenging times like these, good planning becomes even more important. In addition to responding to the current pandemic, the School District of Auburndale has also been working to develop a plan to:

- ✓ Ensure adequate operational funding to support programs and services
- ✓ Complete important safety and infrastructure updates
- ✓ Update technical education and science learning environments
- ✓ Improve space for the performing arts

While we considered suspending these planning efforts, we are also aware that our needs are not going away, interest rates remain near historic lows, and there may be a financial benefit to having a finalized project ready once the pandemic subsides. **Therefore, we are asking you to take 10 minutes to complete this survey.**

TAKE THE SURVEY IN ONE OF TWO EASY WAYS

Online:

- 1) Simply go to the survey website: **www.feedback2000.com**
- 2) Enter your Survey Access Number: **NPL6-PHQG-224W-TNT9**
- 3) Take the survey!

By Paper:

If you do not have internet access, please return the survey in the enclosed envelope to any school office, or mail to: School Perceptions, 317 East Washington Street, Slinger, WI 53086.

The Survey Access Number can be used only once. To obtain additional surveys for other adults in your household, please call the District Office at (715) 652-2117.

Please complete the survey by June 24, 2020.

To collect this feedback, we are working with School Perceptions LLC, an independent firm with expertise in conducting community surveys. All survey data is returned to School Perceptions to ensure respondent anonymity.

Final survey results will be reported at a July Board of Education meeting and will also be available on the District website at www.aubschools.com.

Sincerely,

School District of Auburndale Board of Education

Jamie Delikowski
District Administrator
School District of Auburndale

Dave Homb
Pamela de Boer

Dale A. Aue
Susan Raab

Marleen Knutson

Respondent Information Please check your response to each of the following:

What is your age? Under 18 18-25 26-34 35-54 55-64 65 and over

Do you live in the School District of Auburndale? Yes No

In which municipality do you reside?

- Town of Carson Town of Eau Pleine Town of Day
- Town of Green Valley Village of Arpin Town of Arpin
- Village of Auburndale Town of Auburndale Town of Hansen
- Town of Milladore Town of Richfield Town of Sherry
- Do not live in the District

Are you an employee of the School District of Auburndale? Yes No

Do you have child(ren) attending school in the District? Yes No

If you have school-aged children, what school(s) do they attend? (Mark all that apply)

- Auburndale Elementary Auburndale Middle School Auburndale High School
- Home schooled Public school outside of District Virtual/online school
- Other

Communication Good communication is critical to our mission.

How would you like to receive school/District information? (Mark all that apply)

- District mailings Attend School Board meetings Email
- School website School newsletters Local radio
- Automated phone notification *Marshfield News Herald* Facebook
- Parent/teacher organizations *Hub City Times* Twitter
- Attend meetings at school Text message Other: _____

Financial Background

The Auburndale School District works hard to be good stewards of taxpayers' dollars. The District's tax mill rate, which is used to calculate property taxes, is the lowest in the area and \$1.55 below the area's average.

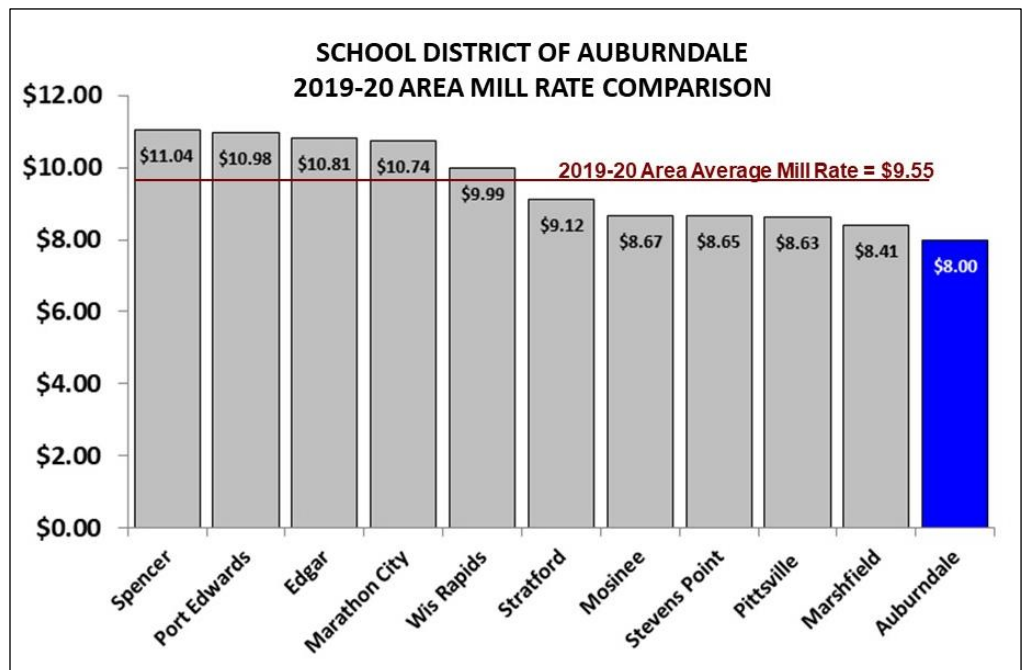

Funding to Support Operations

We are very grateful for the support our community continues to provide our schools. In 2016, our community supported two operational referenda that allowed the District to maintain current programs and services. **The funding from the 3-year non-recurring operational referendum will end next year.**

The District will need to secure a \$200,000 operational referendum in order to maintain current programs and services. If voters do not support a referendum, the District will need to make significant cuts in order to balance the budget.

Would you support a \$200,000 operating referendum in order to maintain current programs and services on a recurring basis?	<input type="checkbox"/> Yes <input type="checkbox"/> No <input type="checkbox"/> Undecided
--	---

Comments/suggestions:

Facility Planning Background

In addition to addressing the District's operational needs, school leaders have been exploring how best to update our facilities. The District hired Eppstein Uhen Architects and Miron Construction to complete a *Facilities Assessment*. The review evaluated the condition of each school and adequacy of the educational spaces.

The study identified the following needs:

Safety/Security and Accessibility

Ensuring safe and accessible facilities is a top priority. While all of the District's buildings are secure, there are improvements that could be made to better control visitor access. Creating dedicated space for District administration, as well as direct access to spaces community members can utilize during the school day, are recommended. In addition, there are opportunities to improve restrooms and locations with elevation changes to ensure accessibility for all guests.

Aging Infrastructure

The District has worked hard to maintain our buildings within our annual operating budget. However, major building systems including heating/ventilation, electrical, and plumbing have exceeded their useful life and are in need of complete replacement or component updates. Portions of the buildings' roofs and windows are old, inefficient, and in need of replacement.

Outdated Educational Spaces

Many of our classrooms and labs have not been updated in several decades. As a result, classrooms are too small and lack the flexible learning environment needed for large group instruction, small group collaboration, and project-based/hands-on learning opportunities for students. In addition, the science classrooms and labs do not have adequate infrastructure or the electrical capacity to support existing equipment and technologies needed for today's educational programming.

Expand Support Spaces for School and Community Use

There is a need to expand and improve the fitness spaces to better meet the health, physical education, and science course requirements. In addition, the space could be better designed for student athletes and community use. The schools' cafeterias are small, and the spaces could be redesigned to improve traffic flow, food serving, and serve as a large group space for school and community use. In addition, the District and community lack a performance space for plays, musicals, recitals, concerts, large group activities, or presentations.

If the community chooses to complete these projects, the primary way to obtain funding is through a capital referendum. **A capital referendum is the method a district must use to issue debt to pay for major facility projects.** Much like a home mortgage, a capital referendum is typically financed over an extended period of time, often 20 years.

Base Plan

The District reviewed the facility assessment and identified a list of potential projects, but acknowledged that it may not be realistic to complete all of the needed updates at one time. Therefore, they have **identified a Base Plan that includes the most critical needs of the District** that could be funded through a capital referendum.

Auburndale Elementary School

- Update HVAC, plumbing, and electrical system components that have exceeded service life
- Replace roof sections and single pane windows
- Replace portions of the ceiling
- Replace fixtures and renovate main restrooms
- Renovate the little theater to serve as a multipurpose space
- Upgrade playground equipment

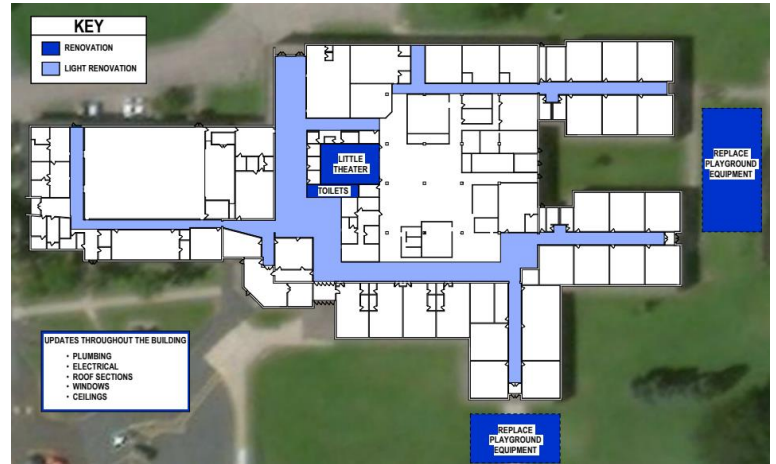

Estimated cost for Elementary School updates: \$1.9 million

Auburndale Middle/High School

- Update HVAC, plumbing, and electrical system components that have exceeded their service life
- Update and expand the technical education, agriculture, and family and consumer education (FACE) classrooms and labs to allow for access to current equipment and job-like experiences
- Replace the greenhouse for science and agriculture education courses
- Repair building exterior and patch cracked masonry
- Repair parking lots
- Replace roof sections and single pane windows
- Replace worn flooring and ceilings
- Replace fixtures and renovate restrooms

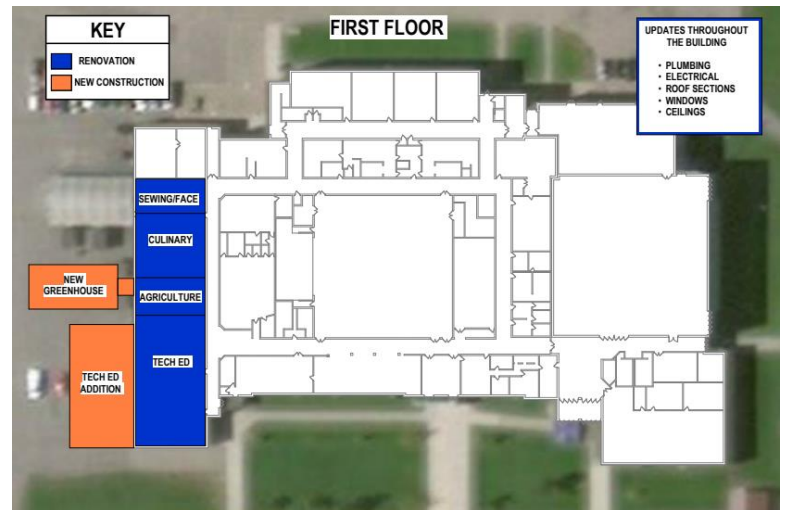

Estimated cost for middle/high school updates: \$5 million

Funding Support:

Operating Referendum \$200,000

Base Plan \$6.9 million

Would you support a \$200,000 operating referendum AND a \$6.9 million capital referendum for the *Base Plan* as described above?

Representing an estimated annual tax increase of approximately \$43 for each \$100,000 of property value.

- Definitely yes
- Probably yes
- Undecided
- Probably no
- Definitely no

Comments/suggestions:

Additional Projects

In addition to addressing the District’s most pressing needs, the following projects could be added to a potential referendum.

Update Science Classrooms and Labs at the Middle/High School

The high school science classrooms have not been significantly renovated since 1964. Redesign of the original construction will improve flexibility, allow better access to technology, and provide space for additional project-based learning activities. The lab stations require updates to plumbing and cabinetry as well as modifications to meet Americans with Disabilities Act (ADA) code compliance.

Estimated Cost: \$1.2 million

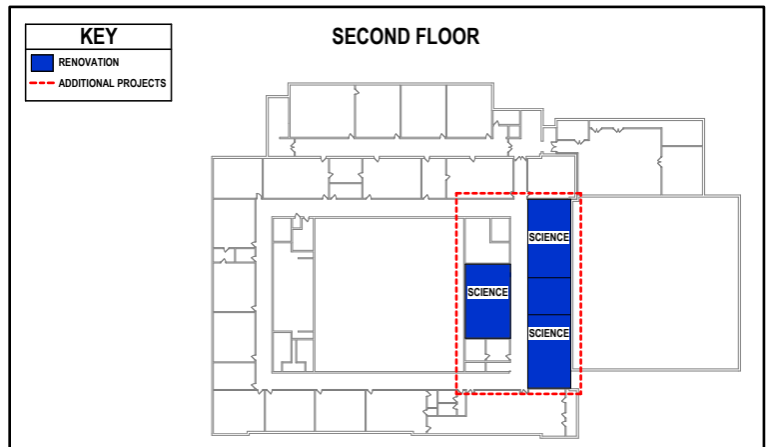

Expand the Cafeteria

The high school cafeteria is too small to meet the needs of the current student population, resulting in students waiting extended times in serving lines during their lunch period. The current floorplan does not allow for efficient traffic flow of students, nor does it allow it to be used as a large group/commons gathering space for school and community use.

Estimated Cost: \$900,000

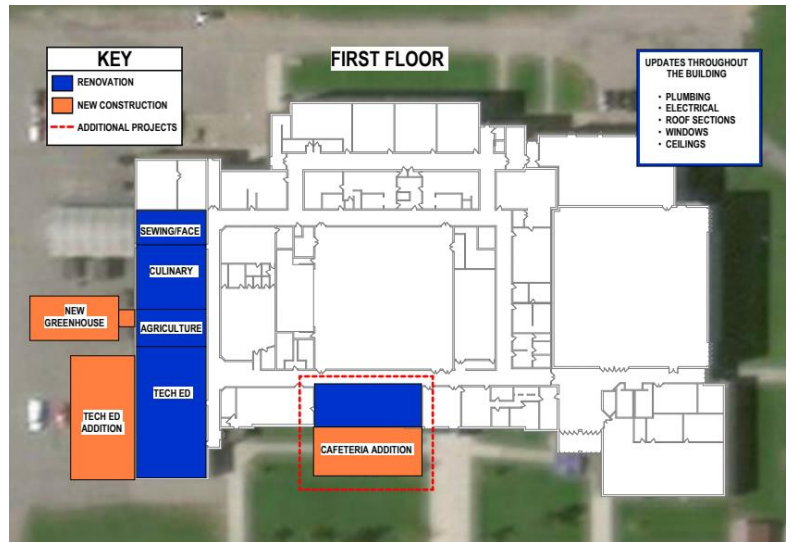

Funding Support:

Operating Referendum	\$200,000
Base Plan	\$6.9 million
Update Science Classrooms and Labs	\$1.2 million
Expand the Cafeteria	\$900,000
Total: \$9 million	

Would you support a \$200,000 operating referendum AND a \$9 million capital referendum as described above?

Representing an estimated annual tax increase of approximately \$70 for each \$100,000 of property value.

- Definitely yes
- Probably yes
- Undecided
- Probably no
- Definitely no

Comments/suggestions:

The referendum could be further expanded to include:

Build a Health Sciences Learning Center

The District could add a new space for hands-on learning in the fields of health and science. An education-based wellness center could be use by health, science, and physical education classes as well as for athletic training and rehabilitation. In addition, by relocating the existing space from the school’s interior to an exterior location with a secure entrance, community members will be able to utilize the space without needing to access the rest of the school.

Estimated Cost: \$ 1.3 million

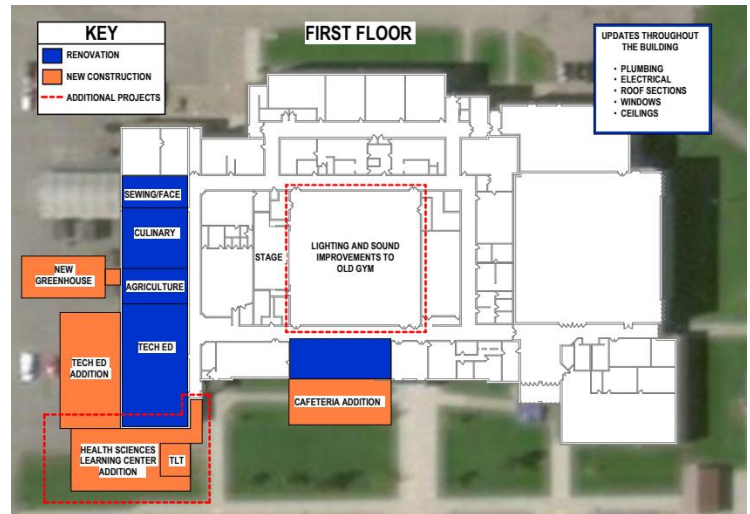

Improve Performance Space in the Old High School Gym

Currently, the District uses the old high school gym stage for musical performances, plays, and presentations. The stage in the gym could be improved with additional stage lighting and an improved sound system.

Estimated Cost: \$300,000

Create a Dedicated District Office

The District would like to consolidate administrative offices to one common location to improve operating efficiencies and create better access for the public. Space on the south end of the elementary school could be renovated for offices, confidential meeting rooms, and a dedicated secure entrance that separates visitors from the elementary school.

Estimated Cost: \$600,000

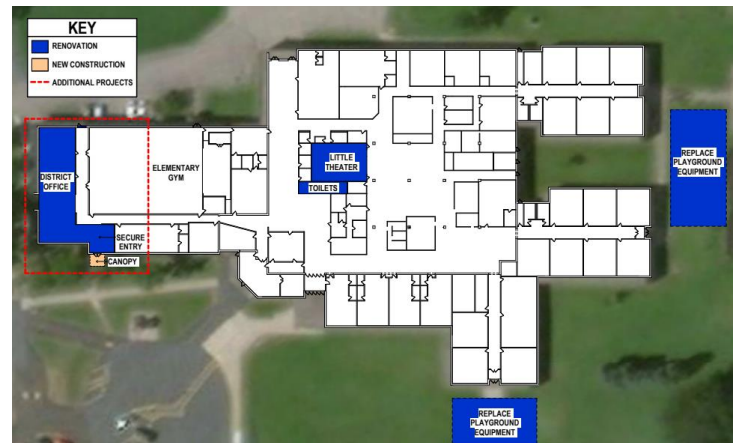

Funding Support:

Operating Referendum	\$200,000
Base Plan	\$6.9 million
Update Science Classrooms and Labs	\$1.2 million
Expand the Cafeteria	\$900,000
Health Sciences Learning Center	\$1.3 million
Improve Performance Space	\$300,000
Create a Dedicated District Office	\$600,000

Total: \$11.2 million

Would you support a \$200,000 operating referendum AND an \$11.2 million capital referendum as described above?

Representing an estimated annual tax increase of approximately \$98 for each \$100,000 of property value.

- Definitely yes
- Probably yes
- Undecided
- Probably no
- Definitely no

Comments/suggestions:

Community Performing Arts Center

The District has heard from many members of the community that there is value in having a dedicated space that could be used by both the school and community for plays, musicals, recitals, concerts, large group activities, and community presentations. Currently, when these events are held in the old gym, it causes scheduling challenges to the gym's already busy schedule.

A Community Performing Arts Center could be built that would include:

- ✓ Seating for 600 people
- ✓ Expanded stage
- ✓ Control booth for sound and lighting
- ✓ Dedicated lobby
- ✓ Additional parking

Estimated Cost: \$3.6 million

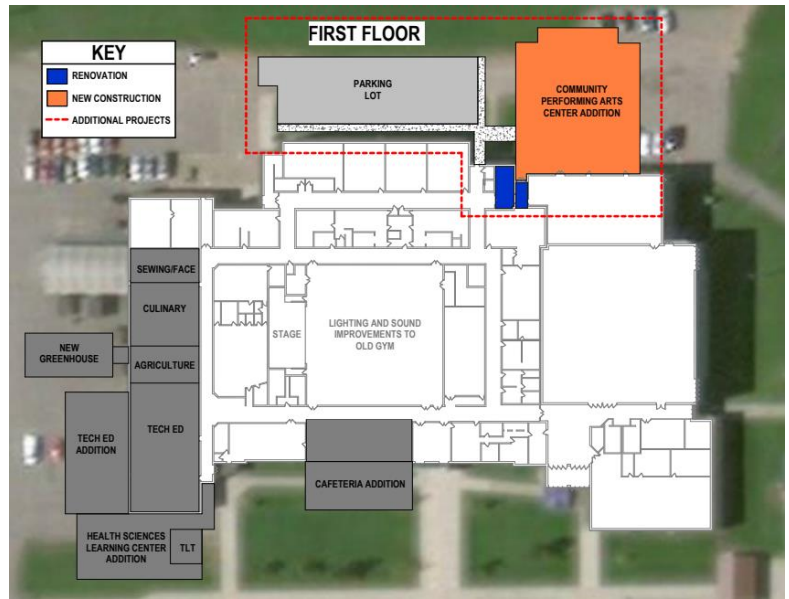

Would you support the District expanding the capital referendum to include an additional \$3.6 million to build a Community Performing Arts Center?

Representing an ADDITIONAL estimated annual tax increase of approximately \$52 for each \$100,000 of property value.

- Definitely yes
- Probably yes
- Undecided
- Probably no
- Definitely no

If the community does not want to expand the capital referendum at this time, a Community Performing Arts Center could be built at a later date. It is important to note that due to the increasing cost of construction and the likelihood that interest rates will rise, completing this project in the future will be more expensive than current cost estimates.

When do you feel the District should build a Community Performing Arts Center?

- I support building it now
- Within 2-3 years
- Within 3-5 years
- Within 6-10 years
- Never
- Undecided

Comments/suggestions:



SCHOOL DISTRICT OF AUBURNDALE
P.O. BOX 139
AUBURNDALE, WI 54412-0139

NON PROFIT ORGN.
U.S. POSTAGE
ECRWSS
AUBURNDALE, WI
PERMIT NO. 7

LOCAL
POSTAL CUSTOMER

Please complete the survey by June 24, 2020.

This publication was produced for the residents of the School District of Auburndale. Due to the overlap of postal routes, residents from neighboring school districts may receive this publication. Given the limitations of bulk mailing, this overlap was difficult to eliminate without significant cost. Thank you for your understanding.